



### Set vibration grade:

there are ten level of intensity of vibration, increase from level 0 to level 9 , and customers can set different class as per their demands. Only when the vibration strength reaches the certain set value, can the emitter be triggered and then emit signal to withdraw the roller blinds. The emitter will emit signal three times after it detects the vibration, thus can make sure to withdraw the roller blinds. level 1 is the most sensitive one, level 9 is the least. level 0 sense nothing.



place the cover after operation, it will enter the normal working statue.

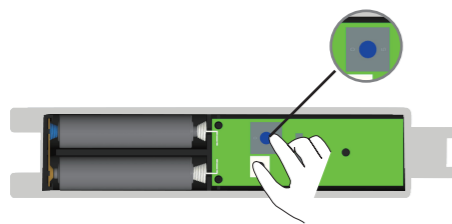

open the outer shell, transmitters have 0 ~ 9 grades switch which used for dial the code for your choose



### Working principle:

If vibration continues, the sensor will stand by after motor closed; if vibration happens randomly, the motor will standby directly.



DC510

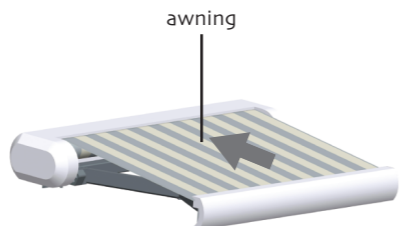

pack up awning

When there is a vibration, reaching setting point, DC510 launch three times code. (30s quit the sense statue after one order is transmitted)



All controls support 433MHz  
All controls support 3V  
All the parameters to the nameplate shall prevail

**Electronic D**  
control awning open and close through vibration sensor

## DC510 shake sensor Specification



Version No : A/01



### Technical Support

when coltage is below 2.2V, it will beep every 5s to remind the battery changing.

### Button specification

multi-function button: 0 level--set button, 5 level--up button, 9 level--down button.



DC510

power supply voltage: DC 3 V (two batteries of number seven)  
Working temperature: -20°C~55°C  
Emission power: 10 milliwatt

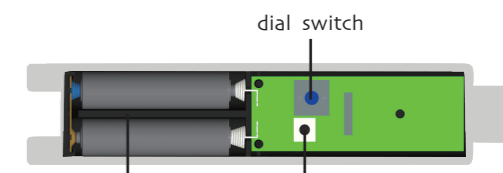

batteries multi-function button



### Method of use

Match with E and R motors:

after the vibration reaches the set level, the awning will open, then press multi-function button with a beep hint, but do not release, then a beep again as a hint of direction changed.

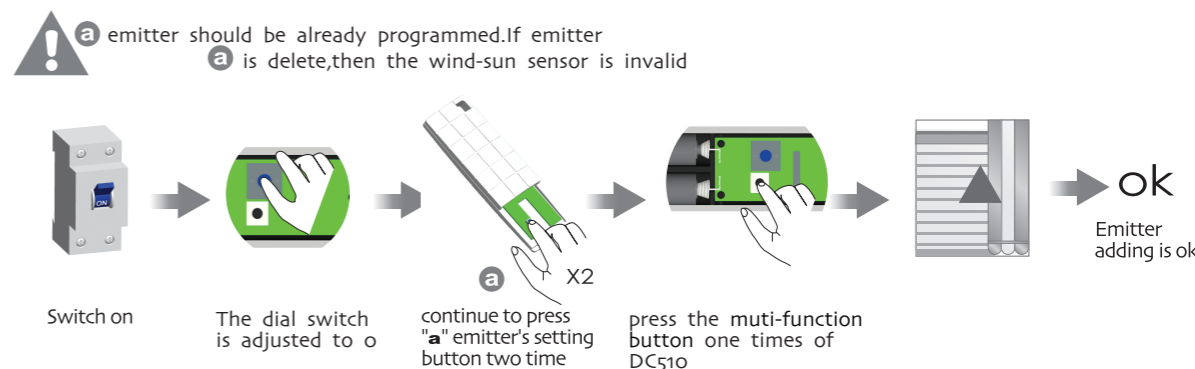

Match with DC136:

The interval of different button must within 10 seconds for all setting, otherwise the system will restore the original state. One receiver store 20 emitters channels at most, and one channel of emitter can control 20 receivers at most.

